

GEN SERIES

NEW

TABLETOP ROBOTIC WELDING MACHINES

Compact | Faster | Cost Effective





"The Strong Start"

GEN S1



Collaborative



Efficient



Compact

Main Components

Collaborative Robot	Welding Torch	Storage Area
Control Unit	Welding Wire Feeder	Water Level
Welding Machine	Slag Compartment	Wire Spool Bracket

Key Features:

- **Safe Collaboration:** It can work safely in the same workspace as the operator. Unlike traditional industrial robots, it usually does not require additional safety fencing.
- **High Repeatability:** It ensures the same welding quality every time, regardless of part geometry or size. This reduces the error rate and raises production standards.
- **Flexible Production:** Switching between different parts and adapting production to orders is extremely easy. This flexibility reduces processing time and production costs.

Areas of Use:

- Machine Manufacturing
- Iron and Steel Industry
- Construction and Steel Construction

Target

- SMEs
- Workshops
- Construction sites



Technical Specifications:

Systems			
Model	GEN-S1		
Dimensions (W x D x H)	1200 x 1100 x 1100 mm		
Robot Specs			
Brand	Fanuc		
Model	CRX-10iA		
Axis	6		
Payload	10 kg		
Access Distance	1249 mm		
Repeability	± 0.04 mm		
Welding Power Source			
Standart		Optional	
Brand	FION MSP500*	Brand	ESAB Aristo 500ix
Type	MIG/MAG	Type	MIG/MAG
Current	3-500 A	Current	5-500 A
Voltage	400 V	Voltage	380-460 V
Welding Table			
Brand	Siegmund		
Dimensions (W x D)	1000 x 1000 mm		
Hole Dia.	16 mm		

* 3 Current Options: 300 A, 400 A, 500 A

Option List:

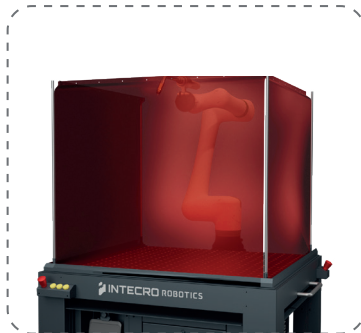

Pneumatic Curtain

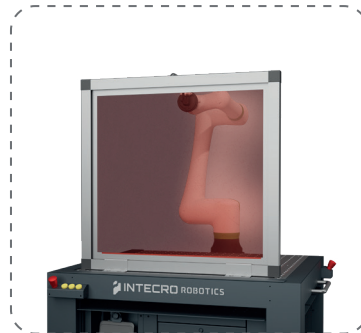

Panel Curtain



External Fume Extractor



Automatic Torch Cleaner



Gas Cylinder Cart

Mechanical Dimensions:

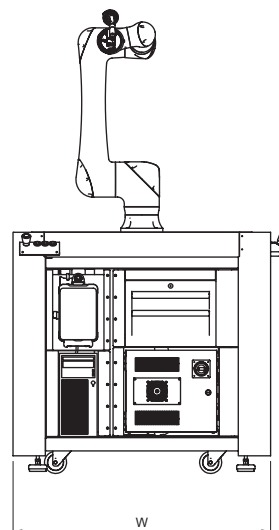
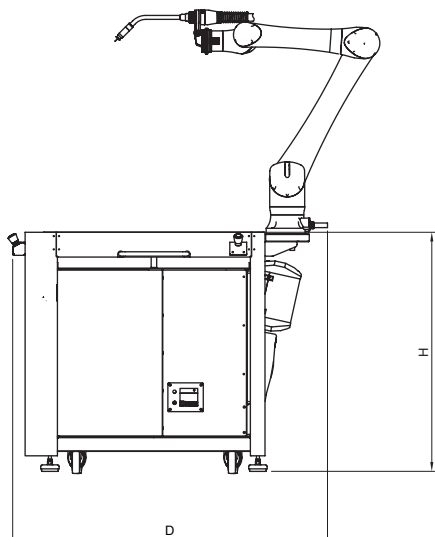

W: 1200 mm
D: 1100 mm
H: 1100 mm

Main Softwares



Arcsense



Touchsense



Multilayer

Software Options:



GEN S2



Collaborative



Efficient



Compact

Main Components

Collaborative Robot	Welding Torch	Storage Area
Control Unit	Welding Wire Feeder	Water Level
Welding Machine	Slag Compartment	Wire Spool Bracket

Key Features:

- **Safe Collaboration:** It can work safely in the same workspace as the operator. Unlike traditional industrial robots, it usually does not require additional safety fencing.
- **High Repeatability:** It ensures the same welding quality every time, regardless of part geometry or size. This reduces the error rate and raises production standards.
- **Flexible Production:** Switching between different parts and adapting production to orders is extremely easy. This flexibility reduces processing time and production costs.

Areas of Use:

- Machine Manufacturing
- Iron and Steel Industry
- Construction and Steel Construction

Target

- SMEs
- Workshops
- Construction sites

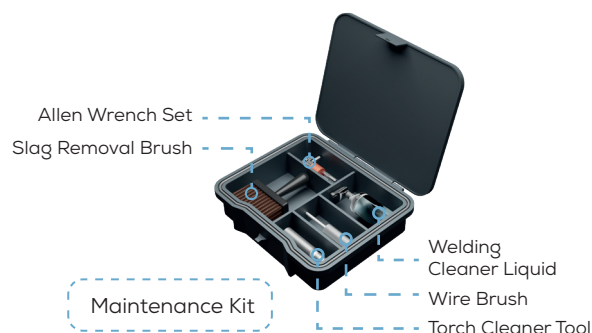

Technical Specifications:

Systems			
Model	GEN-S2		
Dimensions (W x D x H)	1700 x 1100 x 1100 mm		
Robot Specs			
Brand	Fanuc		
Model	CRX-10iA/L		
Axis	6		
Payload	10 kg		
Access Distance	1418 mm		
Repeability	± 0.04 mm		
Welding Power Source			
Standart		Optional	
Brand	FION MSP500*	Brand	ESAB Aristo 500ix
Type	MIG/MAG	Type	MIG/MAG
Current	3-500 A	Current	5-500 A
Voltage	400 V	Voltage	380-460 V
Welding Table			
Brand	Siegmund		
Dimensions (W x D)	1000 x 1500 mm		
Hole Dia.	16 mm		

* 3 Current Options: 300 A, 400 A, 500 A

Option List:



Pneumatic Curtain

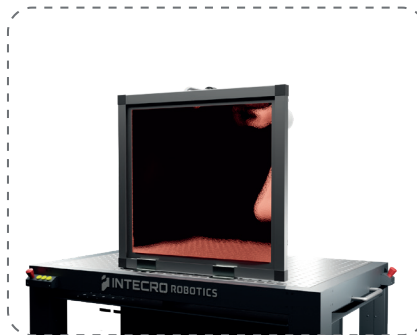

Panel Curtain



External Fume Extractor



Automatic Torch Cleaner



Gas Cylinder Cart

Mechanical Dimensions:

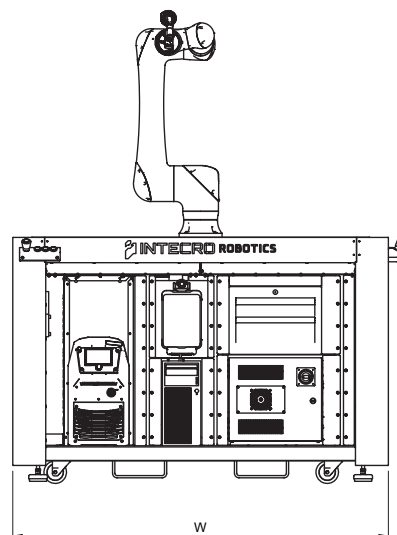
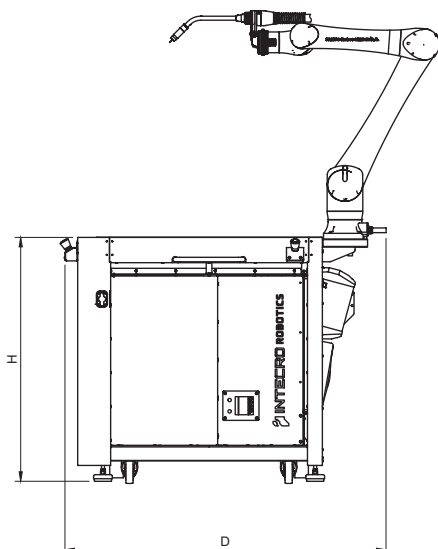

W: 1700 mm
D: 1100 mm
H: 1100 mm

Main Softwares



Arcsense



Touchsense



Multilayer

Software Options:



GEN S3



Collaborative



Efficient



Compact

Main Components

Collaborative Robot	Welding Torch	Storage Area
Control Unit	Welding Wire Feeder	Water Level
Welding Machine	Slag Compartment	Wire Spool Bracket

Key Features:

- **Safe Collaboration:** It can work safely in the same workspace as the operator. Unlike traditional industrial robots, it usually does not require additional safety fencing.
- **High Repeatability:** It ensures the same welding quality every time, regardless of part geometry or size. This reduces the error rate and raises production standards.
- **Flexible Production:** Switching between different parts and adapting production to orders is extremely easy. This flexibility reduces processing time and production costs.

Areas of Use:

- Machine Manufacturing
- Iron and Steel Industry
- Construction and Steel Construction

Target

- SMEs
- Workshops
- Construction sites

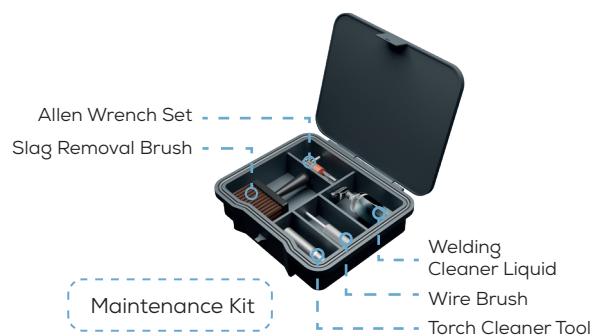

Technical Specifications:

Systems			
Model	GEN-S3		
Dimensions (W x D x H)	2200 x 1100 x 1100 mm		
Robot Specs			
Brand	Fanuc		
Model	CRX-30iA		
Axis	6		
Payload	25-30 kg		
Access Distance	1756-1889 mm		
Repeability	± 0.05 mm		
Welding Power Source			
Standart	Optional		
Brand	FION MSP500*	Brand	ESAB Aristo 500ix
Type	MIG/MAG	Type	MIG/MAG
Current	3-500 A	Current	5-500 A
Voltage	400 V	Voltage	380-460 V
Welding Table			
Brand	Siegmund		
Dimensions (W x D)	1000 x 2000 mm		
Hole Dia.	16 mm		

* 3 Current Options: 300 A, 400 A, 500 A

Option List:



Pneumatic Curtain

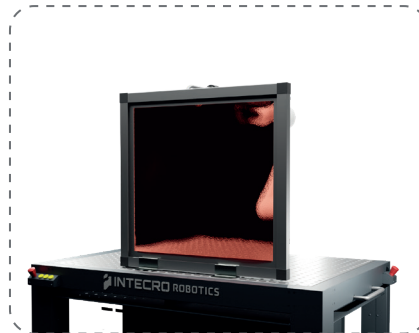

Panel Curtain



External Fume Extractor



Automatic Torch Cleaner



Gas Cylinder Cart

Mechanical Dimensions:

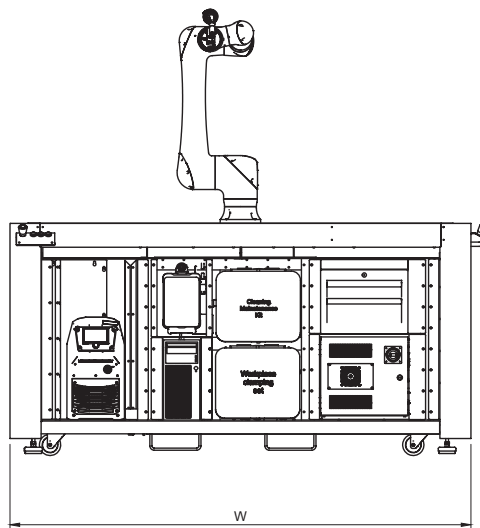
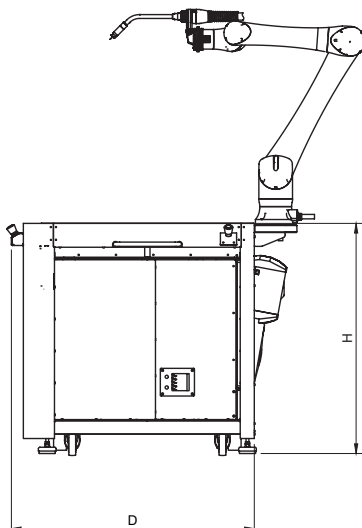

W: 2200 mm
D: 1100 mm
H: 1100 mm

Main Softwares



Arcsense



Touchsense



Multilayer

Software Options:



GEN M

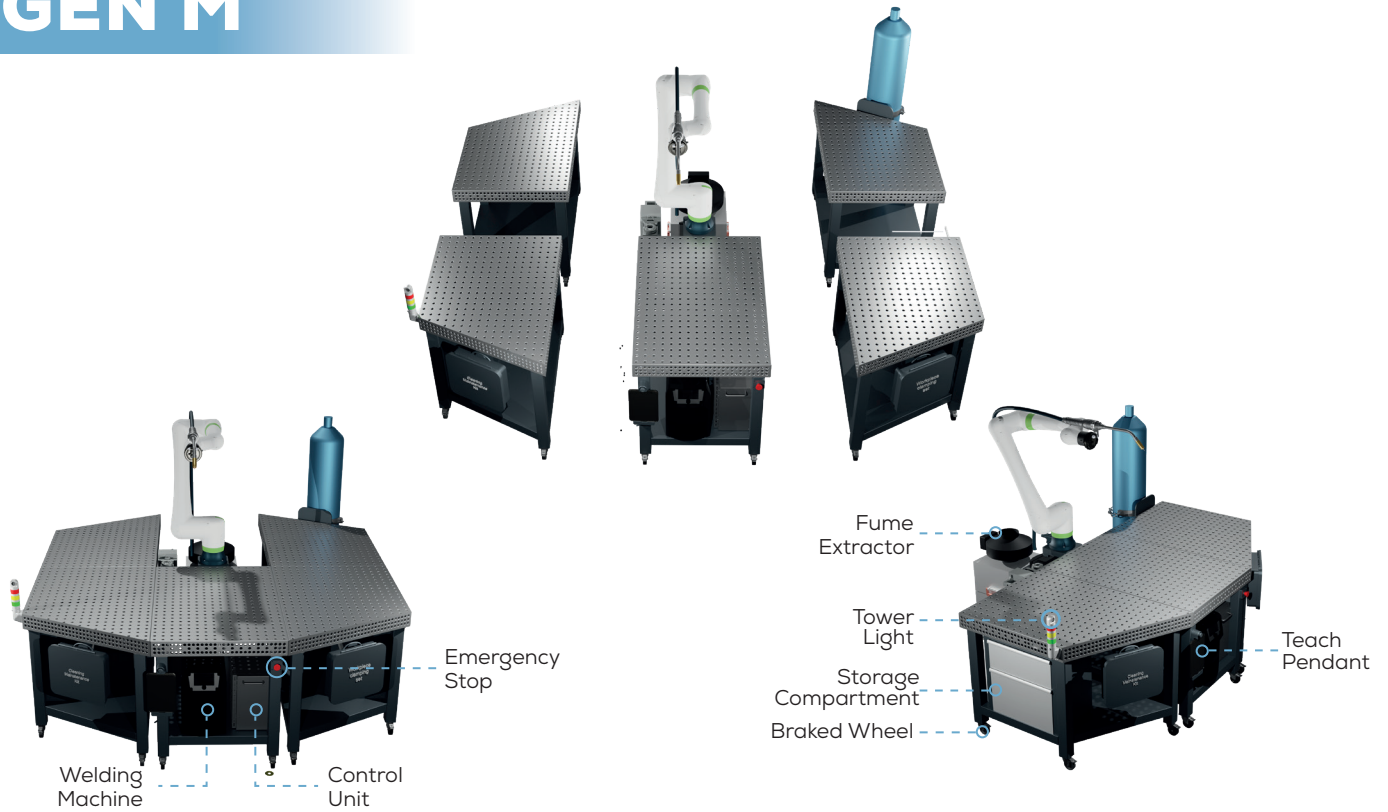

Modular



Scalable



Configurable

Main Components

Collaborative Robot	Welding Torch	Storage Area
Welding Machine	Welding Wire Feeder	Casters & Feet
Modular Welding table	Slag Compartment	Tube Attachment Chain
Safety Equipment	Part Fixing Equipment	Cleaning & Maintenance Equipment

Key Features:

- **Modular Usage:** Thanks to the modular design approach, it can be expanded and reconfigured according to different production needs.
- **Ease of Transport:** With its optimized construction structure, the system can be transported and relocated quickly and practically.
- **Configurable Structure:** It offers a flexible system that can be easily configured according to different process, equipment, and automation needs.

Areas of Use:

- General Industry
- Maintenance-Repair
- Construction

Target

- SMEs
- Workshops
- Factories



Allen Wrench Set
Slag Removal Brush

Maintenance Kit



Welding Cleaner Liquid
Wire Brush
Torch Cleaner Tool

Safety Kit



Welding Gloves



Welding Glasses

Technical Specifications:

Systems			
Model	GEN-M		
Dimensions (W x D x H)	800 x 1500 x 1100 mm		
Robot Specs			
Brand	Fanuc		
Model	CRX-30iA		
Axis	6		
Payload	25-30 kg		
Access Distance	1756-1889 mm		
Repeability	± 0.05 mm		
Welding Power Source			
Standart		Optional	
Brand	FION MSP500*	Brand	ESAB Aristo 500ix
Type	MIG/MAG	Type	MIG/MAG
Current	3-500 A	Current	5-500 A
Voltage	400 V	Voltage	380-460 V
Main Welding Table			
Brand	Siegmond		
Dimensions (W x D)	800 x 1200 mm		
Hole Dia.	16 mm		

* 3 Current Options: 300 A, 400 A, 500 A

Main Softwares



Arcsense



Touchsense



Multilayer

Software Options:



Option List:



Panel Curtain

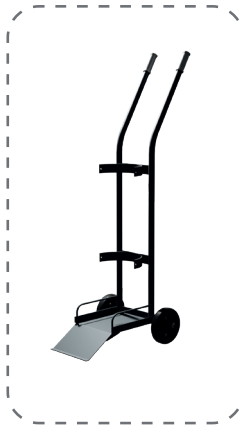

Gas Cylinder Cart



Additional Table Modules
(800 x 1200 mm) (x2 Left + 2x Right)

Mechanical Dimensions:

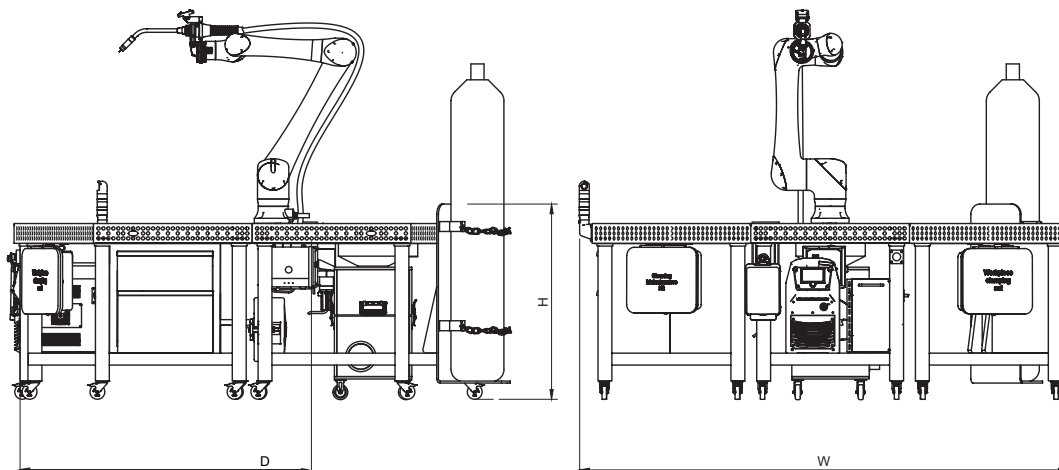

W: 800 mm
D: 1500 mm
H: 1100 mm

GEN C1

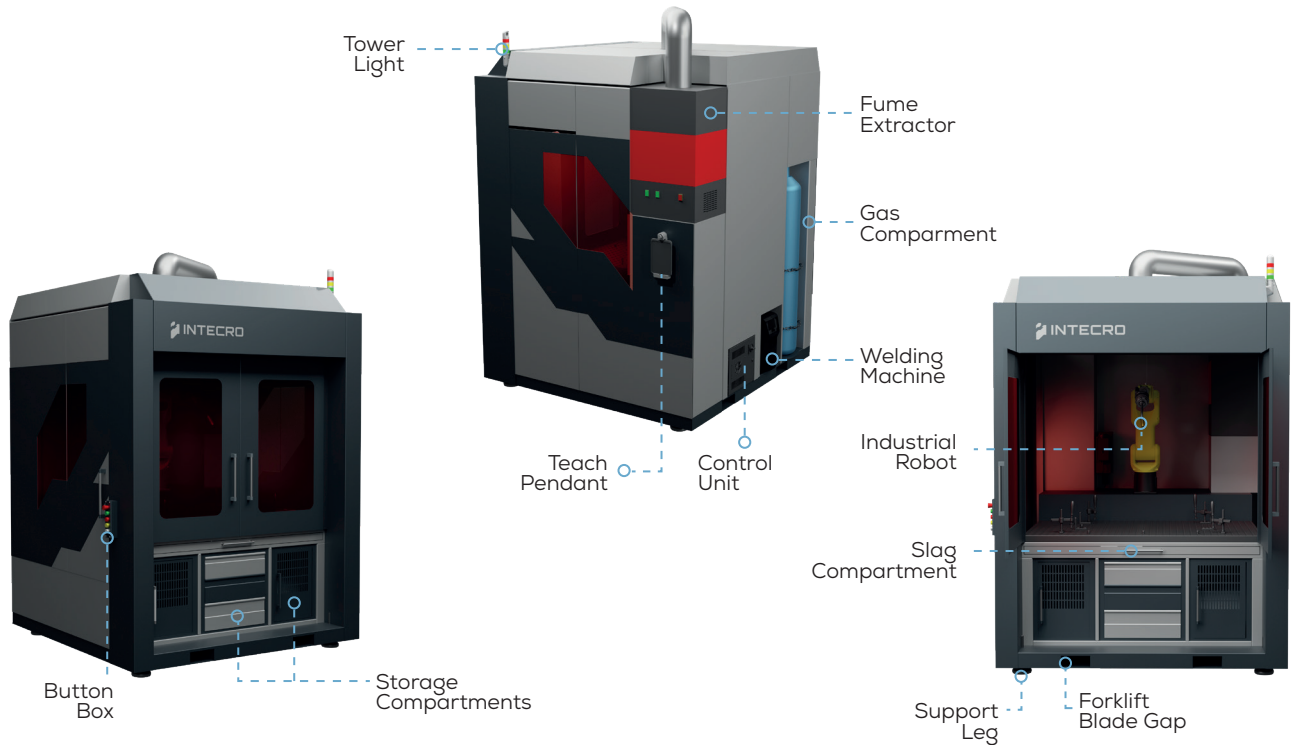

Enclosed



Versatile



Turnkey

Main Components

Industrial Robot	Welding Torch	Storage Area
Welding Machine	Welding Wire Feeder	Welding Fume Extractor
Welding Table	Slag Compartment	Automatic Torch Cleaner
Closed Cabin	Tube Compartment	Forklift Blade Gap
Safety Equipment	Part Fixing Equipment	Cleaning & Maintenance Equipment

Key Features:

- Maximum Safety:** The welding booth provides maximum operator and environmental safety by offering a fully enclosed protective structure equipped with automatic opening and closing protective doors, welding panels, and integrated fume extraction systems.
- All-in-one system:** All components related to the welding operation are integrated into a single system, creating a compact, organized, and efficient working environment.
- Positioner Support:** It allows for the integration of additional positioners for welding workpieces with different and complex geometries, increasing process flexibility.

Areas of Use:

- Manufacturing
- Assembly
- Heavy Industry

Target

- SMEs
- Workshops
- Factories

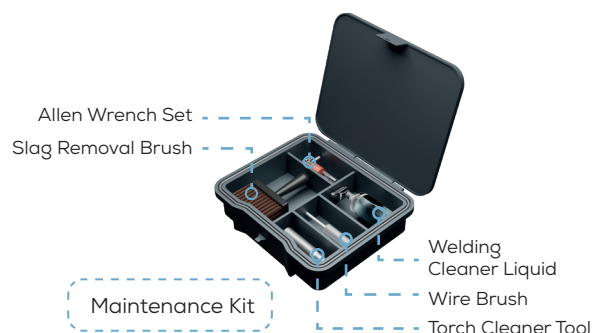

Technical Specifications:

System			
Model	GEN-C1		
Dimensions (W x D x H)	2000 x 2050 x 3000 mm		
Robot Specs			
Brand	Fanuc		
Model	Arc Mate 100iD		
Axis	6		
Payload	12 kg		
Access Distance	1441 mm		
Repeability	± 0.02 mm		
Welding Power Source			
Standart	Optional		
Brand	FION MSP500*	Brand	ESAB Aristo 500ix
Type	MIG/MAG	Type	MIG/MAG
Current	3-500 A	Current	5-500 A
Voltage	400 V	Voltage	380-460 V
Welding Table			
Brand	Dimensions (W x D)	Hole Dia.	
Siegmund	1000 x 1500 mm	16 mm	

* 3 Current Options: 300 A, 400 A, 500 A

Main Softwares



Arcsense



Touchsense



Multilayer

Software Options:



Option List:



CS + Tailstock	
Capacity	500 kg (Single) 1000 kg (Double)
Turning Dia.	500 mm
Rotational Vel.	0.5 RPM

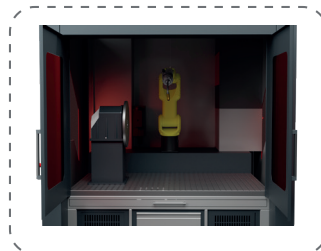

Headstock	
Capacity	500 kg
Turning Dia.	500 mm
Rotational Vel.	0.5 RPM

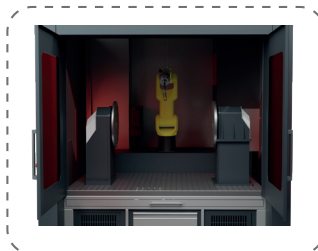

Headstock + Tailstock	
Capacity	500 kg
Turning Dia.	500 mm
Rotational Vel.	0.5 RPM

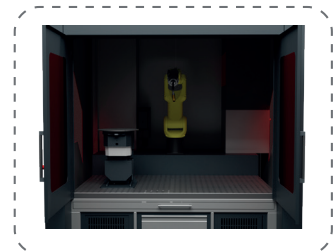

Compact Skyhook (CS)	
Capacity	500 kg
Turning Dia.	500 mm
Rotational Vel.	0.5 RPM

Mechanical Dimensions:

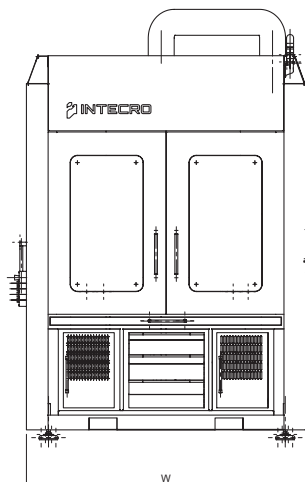
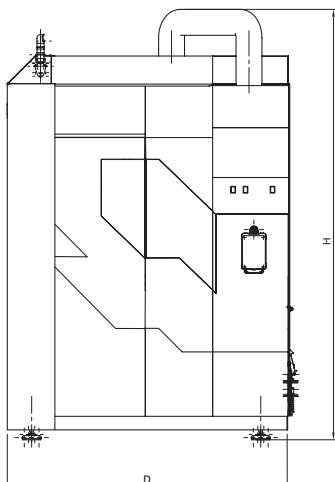

W: 2000 mm
D: 2050 mm
H: 3000 mm

GEN C2

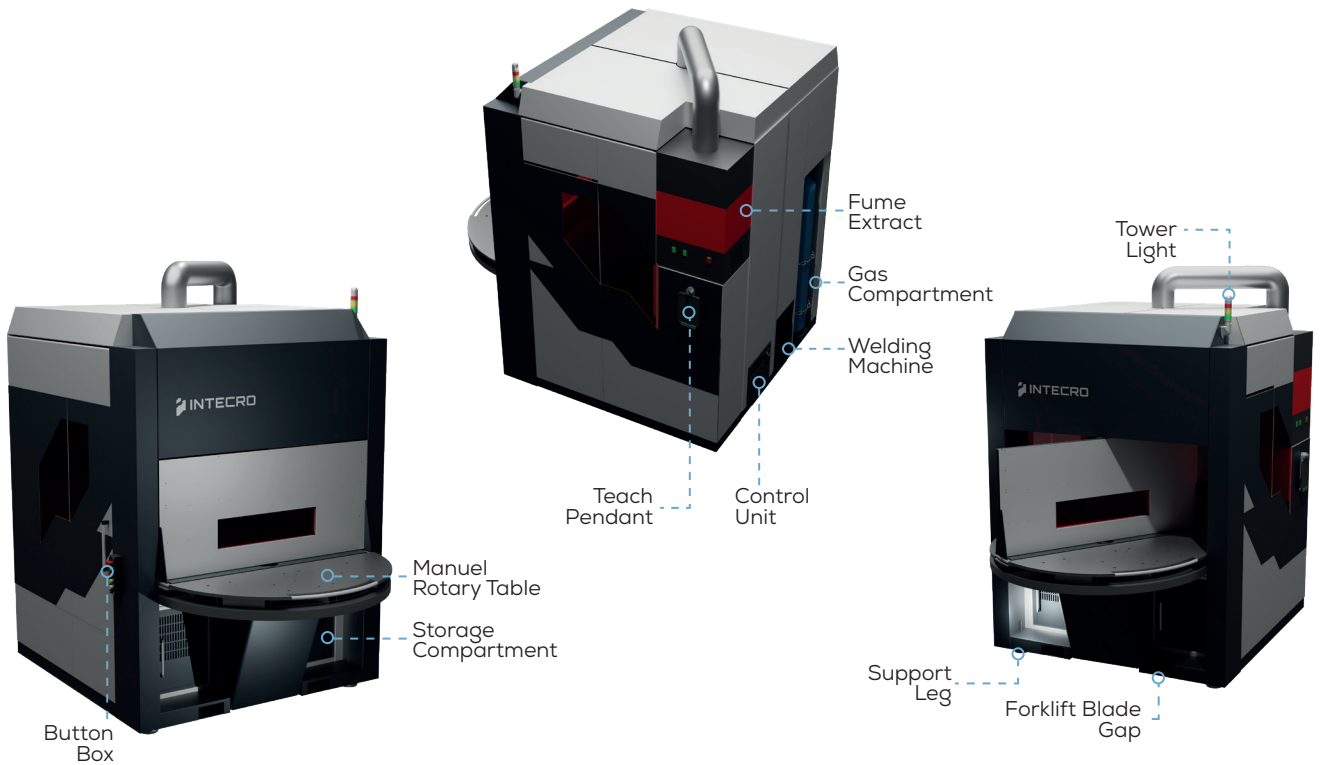

Safe



Productive



Accesible

Main Components

Industrial Robot	Welding Torch	Storage Area
Welding Machine	Welding Wire Feeder	Welding Fume Extractor
Rotary Table	Slag Compartment	Automatic Torch Cleaner
Closed Cabin	Tube Compartment	Rotate Table
Safety Equipment	Part Fixing Equipment	Cleaning & Maintenance Equipment

Key Features:

- **Easy-to-Use Rotary Table:** The manually controlled rotary table structure allows for quick and practical part loading and unloading.
- **Enclosed Cabin Structure:** The enclosed cabin design allows for safe part drop-off and retrieval without the operator needing to enter the cell.
- **Ergonomic Design:** The ergonomic design approach, which prioritizes operator access and enhances ease of use, provides a comfortable and efficient working environment.

Areas of Use:

- Manufacturing
- Assembly
- Heavy Industry

Target

- SMEs
- Workshops
- Factories

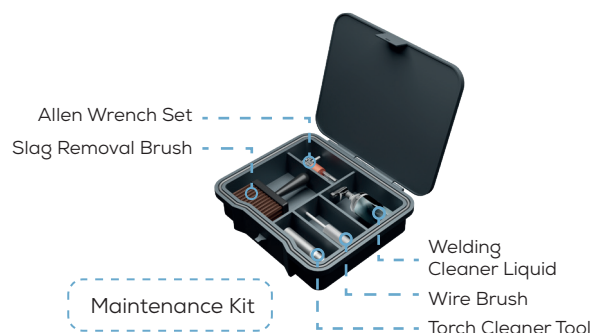

Technical Specifications:

Systems			
Model		GEN-C2	
Dimensions (W x D x H)		2000 x 2050 x 3000 mm	
Robot Specs			
Brand		Fanuc	
Model		Arc Mate 100iD	
Axis		6	
Payload		12 kg	
Access Distance		1441 mm	
Repeability		± 0.02 mm	
Welding Power Source			
Standart		Optional	
Brand	FION MSP500*	Brand	ESAB Aristo 500ix
Type	MIG/MAG	Type	MIG/MAG
Current	3-500 A	Current	5-500 A
Voltage	400 V	Voltage	380-460 V
Rotary Table			
Dimensions (Diameter)		850 mm	
Hole Dia.		16 mm	
Panel Height (Max.)		800 mm	

* 3 Current Options: 300 A, 400 A, 500 A

Option List:



Automatic Rotary Table

Main Softwares



Arcsense



Touchsense



Multilayer

Software Options:



Mechanical Dimensions:

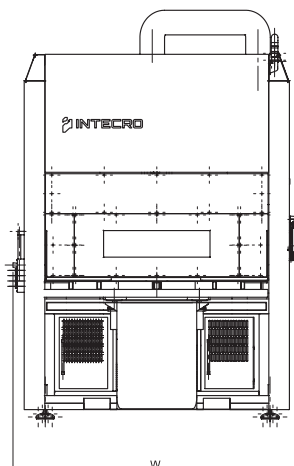
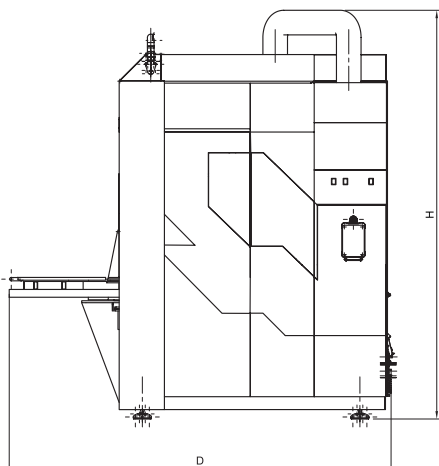

W: 2000 mm
D: 2050 mm
H: 3000 mm

GEN C3

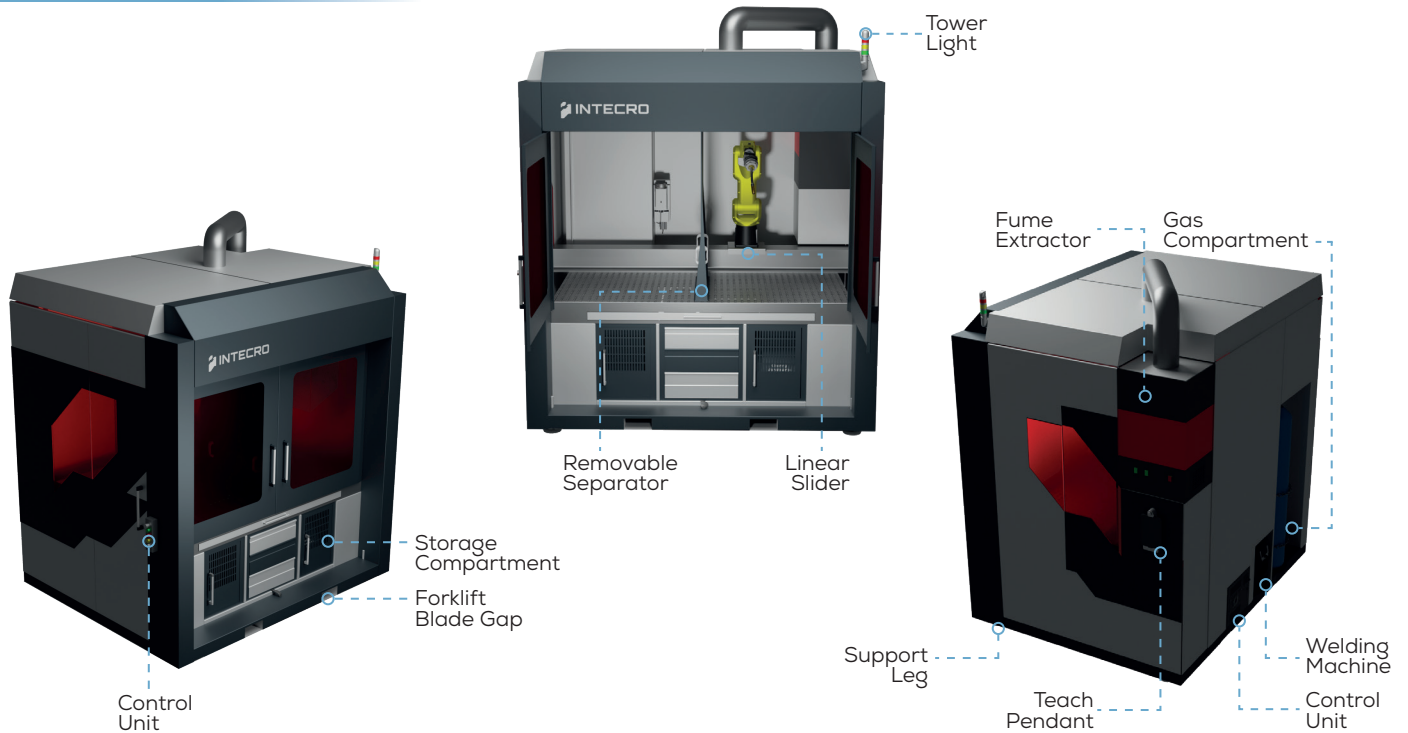

Spacious



Robust



Dynamic

Main Components

Industrial Robot	Welding Torch	Storage Area
Welding Machine	Welding Wire Feeder	Welding Fume Extractor
Forklift Blade Gap	Slag Compartment	Automatic Torch Cleaner
Robot Slider	Dual-Station Welding Table	Tube Compartment
Separator	Foot	Closed Cabin
Safety Equipment	Part Fixing Equipment	Cleaning & Maintenance Equipment

Key Features:

- Large Work Area:** The expanded working volume allows for the easy processing of large workpieces.
- Sliding Robot Structure:** To maximize the robot's access capability within the large work area, it features a sliding table-mounted robot structure and a separator system that supports process safety.
- Positioner Support:** It allows positioners that can secure and rotate the workpiece to be easily and flexibly integrated into the system, enabling the application of different welding paths.

Areas of Use:

- Manufacturing
- Assembly
- Heavy Industry

Target

- SMEs
- Workshops
- Factories



Technical Specifications:

Systems			
Model	GEN-C3		
Dimensions (W x D x H)	2500 x 2050 x 3000 mm		
Robot Specs			
Brand	Fanuc		
Model	Arc Mate 100iD		
Axis	6		
Payload	12 kg		
Access Distance	1441 mm		
Repeability	± 0.02 mm		
Welding Power Source			
Standart	Optional		
Brand	FION MSP500*	Brand	ESAB Aristo 500ix
Type	MIG/MAG	Type	MIG/MAG
Current	3-500 A	Current	5-500 A
Voltage	400 V	Voltage	380-460 V
Welding Table			
Brand	Dimensions (W x D)	Hole Dia.	
Siegmund	1000 x 2000 mm	16 mm	

* 3 Current Options: 300 A, 400 A, 500 A

Main Softwares



Arcsense



Touchsense



Multilayer

Software Options:



Option List:



Double CS	
Capacity	500 kg (Single) 1000 kg (Double)
Turning Dia.	500 mm
Rotational Vel.	0.5 RPM

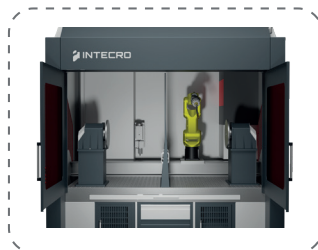

Double Headstock	
Capacity	500 kg (Single) 1000 kg (Double)
Turning Dia.	500 mm
Rotational Vel.	0.5 RPM

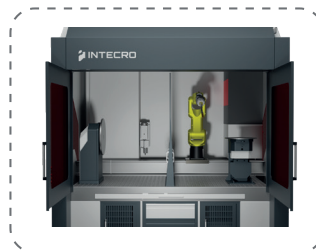

CS + Tailstock	
Capacity	500 kg
Turning Dia.	500 mm
Rotational Vel.	0.5 RPM

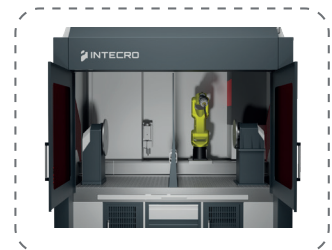

Headstock + Tailstock	
Capacity	500 kg
Turning Dia.	500 mm
Rotational Vel.	0.5 RPM

Mechanical Dimensions:

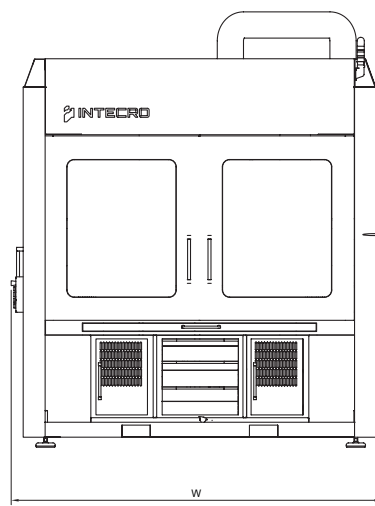
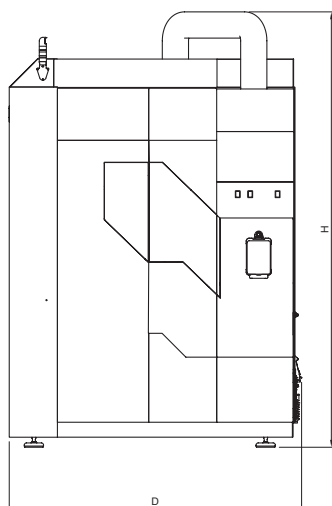

W: 2500 mm
D: 2050 mm
H: 3000 mm

GEN T1



Mobile



Flexible



Free

Main Components

Collaborative Robot	Welding Torch	Storage Area
Welding Machine	Welding Wire Feeder	Transport Cart
Safety Equipment	Part Fixing Equipment	Cleaning & Maintenance Equipment

Key Features:

- **Wide Working Area:** The robot can operate in any accessible area without requiring a welding table.
- **Mobile Use:** Thanks to its wheeled structure or AMR installation, it can be easily moved between work areas.
- **Flexible Operation:** It can perform serial welding operations in manual or autonomous mode.

Areas of Use:

- Transportation
- Energy
- Infrastructure

Target

- Shipyards
- Workshops
- Factories



Technical Specifications:

Systems			
Model	GEN-T1		
Dimensions (W x D x H)	1000 x 1500 x 1200 mm		
Robot Specs			
Brand	Fanuc		
Model	CRX-30iA		
Axis	6		
Payload	25-30 kg		
Access Distance	1756-1889 mm		
Repeability	± 0.05 mm		
Welding Power Source			
Standart		Optional	
Brand	FION MSP500*	Brand	ESAB Aristo 500ix
Type	MIG/MAG	Type	MIG/MAG
Current	3-500 A	Current	5-500 A
Voltage	400 V	Voltage	380-460 V

* 3 Current Options: 300 A, 400 A, 500 A

Option List:

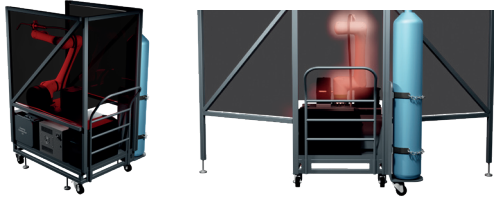

Panel Curtain



External Fume Extractor



Automatic Torch Cleaner

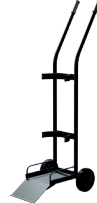

Gas Cylinder Cart

Main Softwares



Arcsense



Touchsense



Multilayer

Mechanical Dimensions:

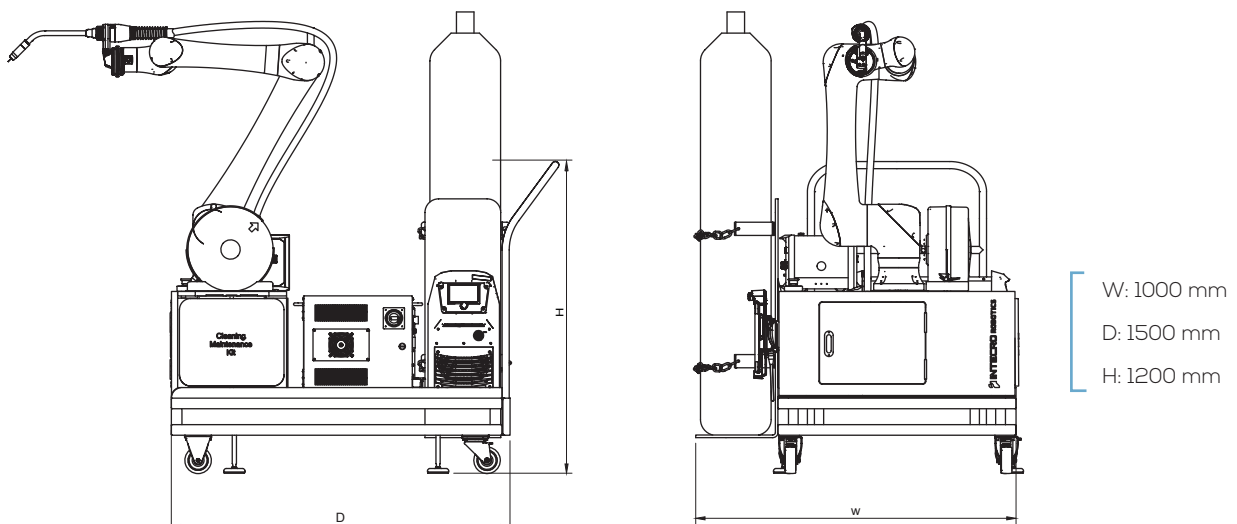

GEN T2

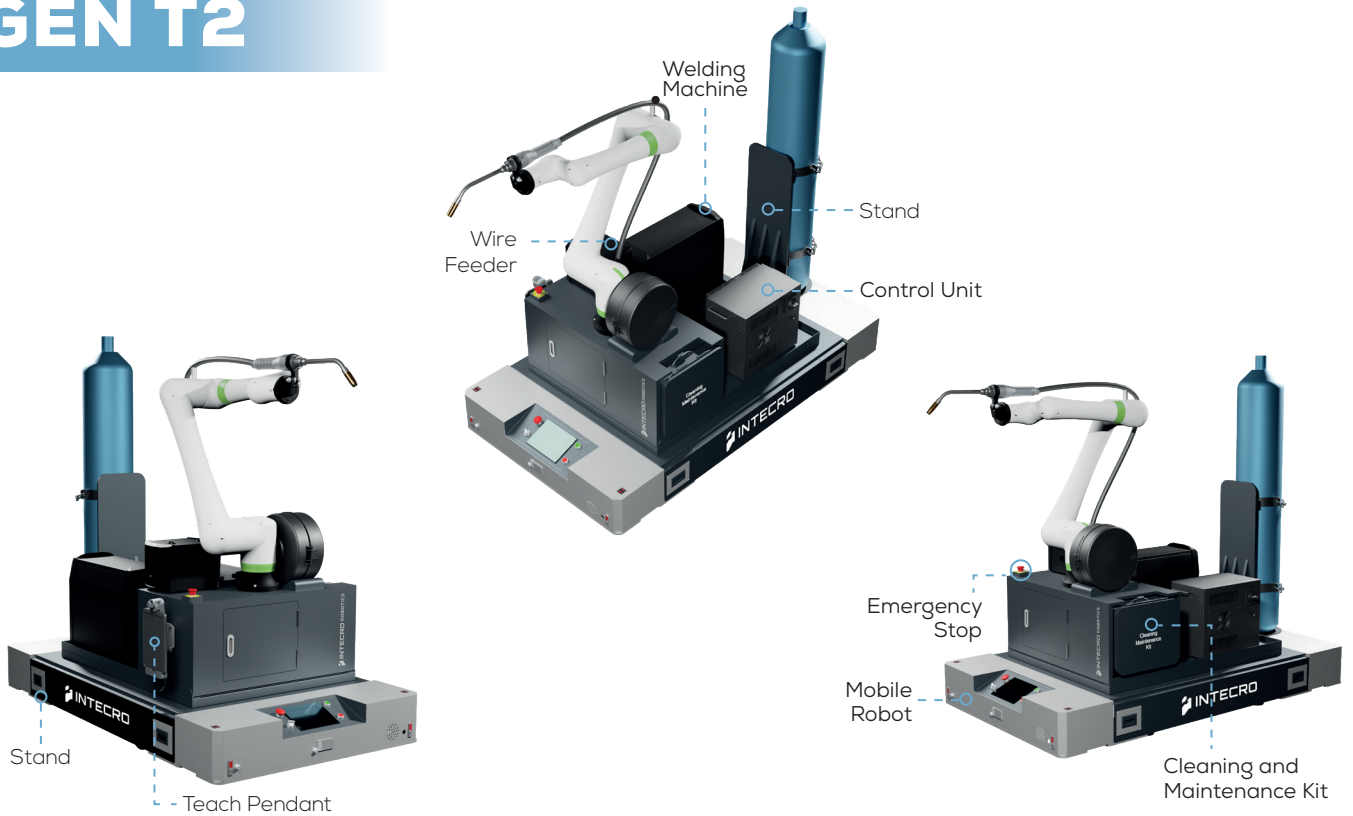

Fast



Autonomous



Agile

Main Components

Collaborative Robot	Welding Torch	Storage Area
Welding Machine	Welding Wire Feeder	Mobile Robot
Safety Equipment	Part Fixing Equipment	Cleaning & Maintenance Equipment

Key Features:

- **Wide Working Area:** The robot can operate in any accessible area without requiring a welding table.
- **Mobile Use:** Thanks to its wheeled structure or AMR installation, it can be easily moved between work areas.
- **Flexible Operation:** It can perform serial welding operations in manual or autonomous mode.

Areas of Use:

- Transportation
- Energy
- Infrastructure

Target

- Shipyards
- Workshops
- Factories

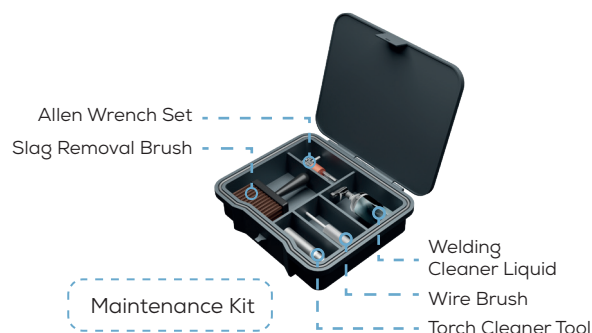

Technical Specifications:

Systems			
Model	GEN-T2		
Dimensions (W x D x H)	1100 x 2000 x 1500 mm		
Robot Specs			
Brand	Fanuc		
Model	CRX-30iA		
Axis	6		
Payload	25-30 kg		
Access Distance	1756-1889 mm		
Repeability	± 0.05 mm		
Welding Power Source			
Standart		Optional	
Brand	FION MSP500*	Brand	ESAB Aristo 500ix
Type	MIG/MAG	Type	MIG/MAG
Current	3-500 A	Current	5-500 A
Voltage	400 V	Voltage	380-460 V

* 3 Current Options: 300 A, 400 A, 500 A

Option List:



Gas Cylinder Cart



Automatic Torch Cleaner



External Fume Extractor

Main Softwares



Arcsense



Touchsense



Multilayer

Mechanical Dimensions:

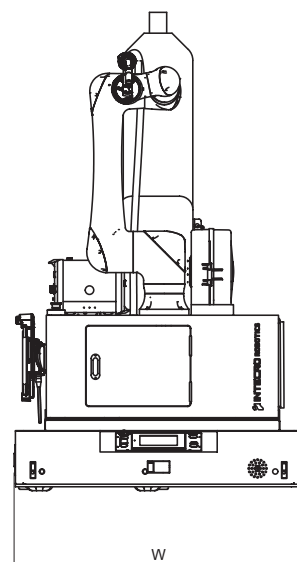
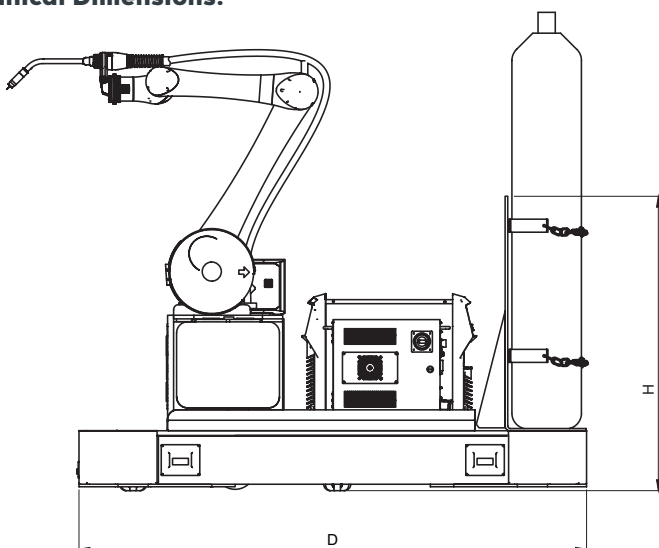

W: 1100 mm
D: 2000 mm
H: 1500 mm

GEN P1

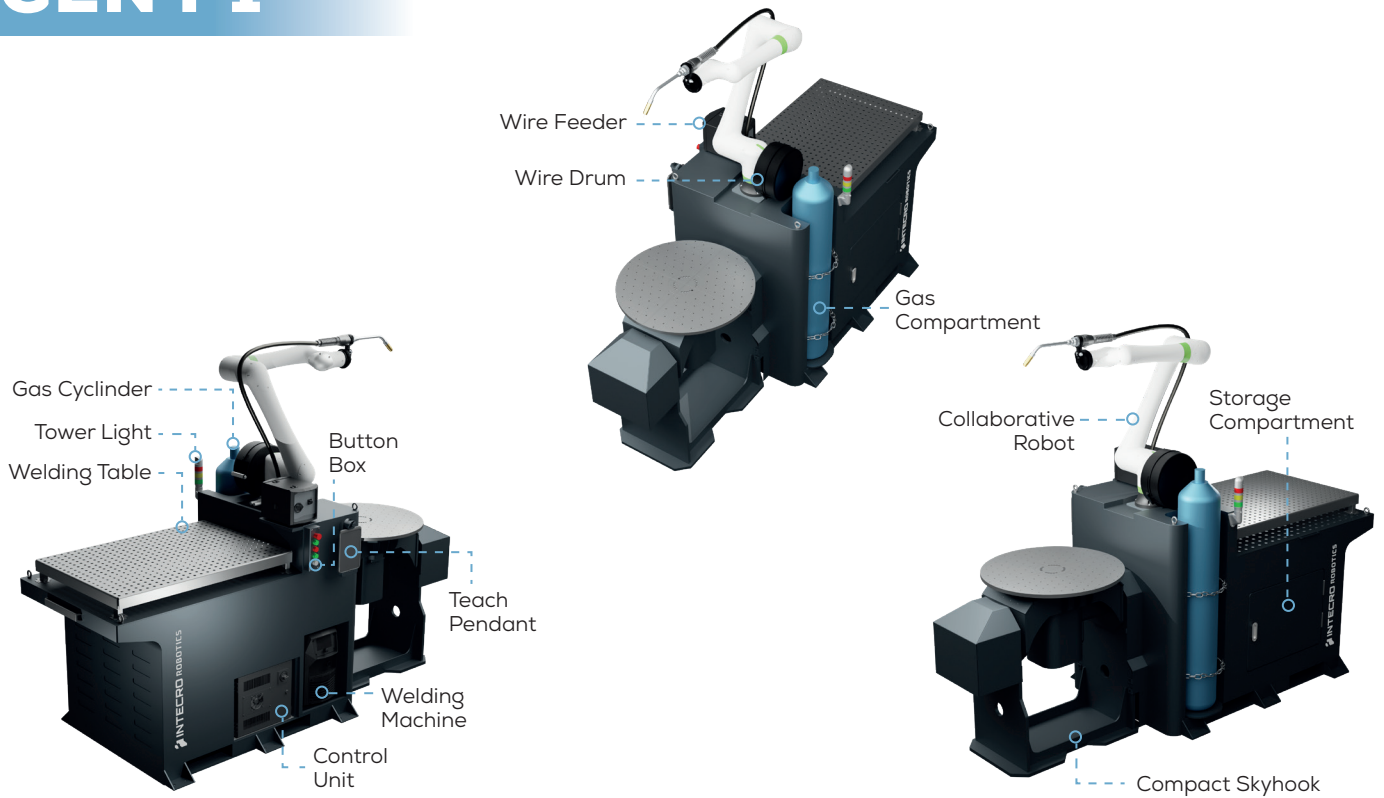

Strong



Rigid



Balanced

Main Components

Collaborative Robot	Welding Torch	Storage Area
Welding Machine	Welding Wire Feeder	Casters & Feet
Positioner	Slag Compartment	Tube Attachment Chain
Safety Equipment	Part Fixing Equipment	Cleaning & Maintenance Equipment

Key Features:

- **Positioner Integrated System:** The positioner integration, which can hold the workpiece and rotate it in a controlled manner, ensures full compatibility with different welding scenarios.
- **Two Different Table Structures:** It offers flexible usage with two separate table configurations designed to suit different production needs.
- **Fixed, Yet Easily Transportable:** While maintaining the stability of a fixed installation, it provides practical use with mobility solutions that facilitate transportation and relocation processes.

Areas of Use:

- Manufacturing
- Automotive
- Infrastructure

Target

- SMEs
- Workshops
- Factories

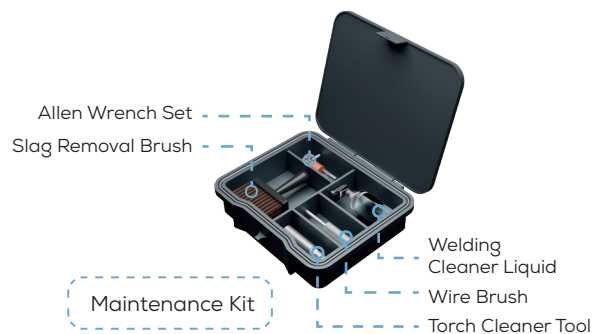

Technical Specifications:

Systems			
Model	GEN-P1		
Dimensions (W x D x H)	1000 x 3000 x 1400 mm		
Robot Specs			
Brand	Fanuc		
Model	CRX-10iA/L		
Axis	6		
Payload	10 kg		
Access Distance	1418 mm		
Repeability	± 0.04 mm		
Welding Power Source			
Standart		Optional	
Brand	FION MSP500*	Brand	ESAB Aristo 500ix
Type	MIG/MAG	Type	MIG/MAG
Current	3-500 A	Current	5-500 A
Voltage	400 V	Voltage	380-460 V
Welding Table		Compact Skyhook	
Brand	Siegmund	Brand	Robital Rhino Motion
Dimensions (W x D)	800 x 1200 mm	Capacity	1000 kg
Hole Dia.	16 mm	Turning Diameter	800 mm
		Rotational Velocity	0.5 RPM
		Repeatability	± 1.5 Arcmin

* 3 Current Options: 300 A, 400 A, 500 A

Main Softwares



Arcsense



Touchsense



Multilayer

Software Options:



Option List:



Gas Cylinder Cart



External Fume Extractor

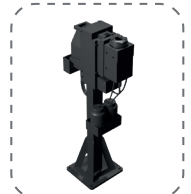

Automatic Torch Cleaner

Mechanical Dimensions:

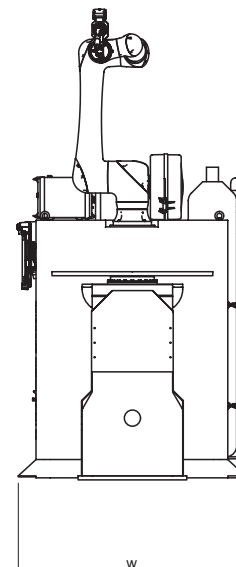
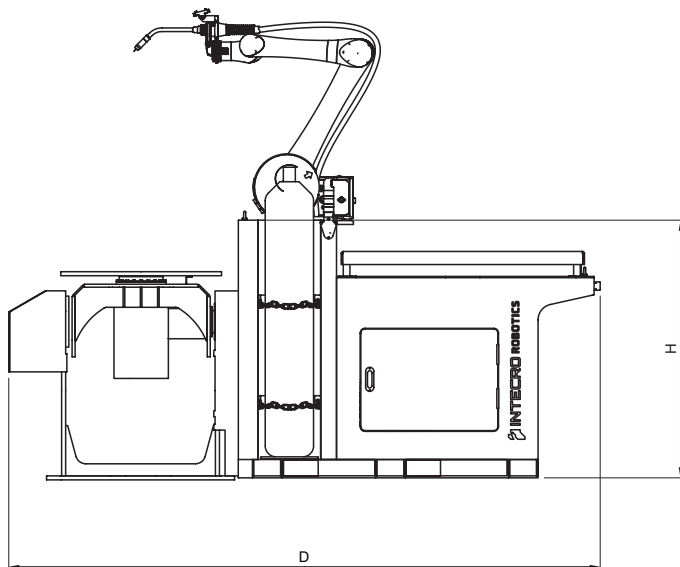

W: 1000 mm
D: 3000 mm
H: 1400 mm

GEN P2

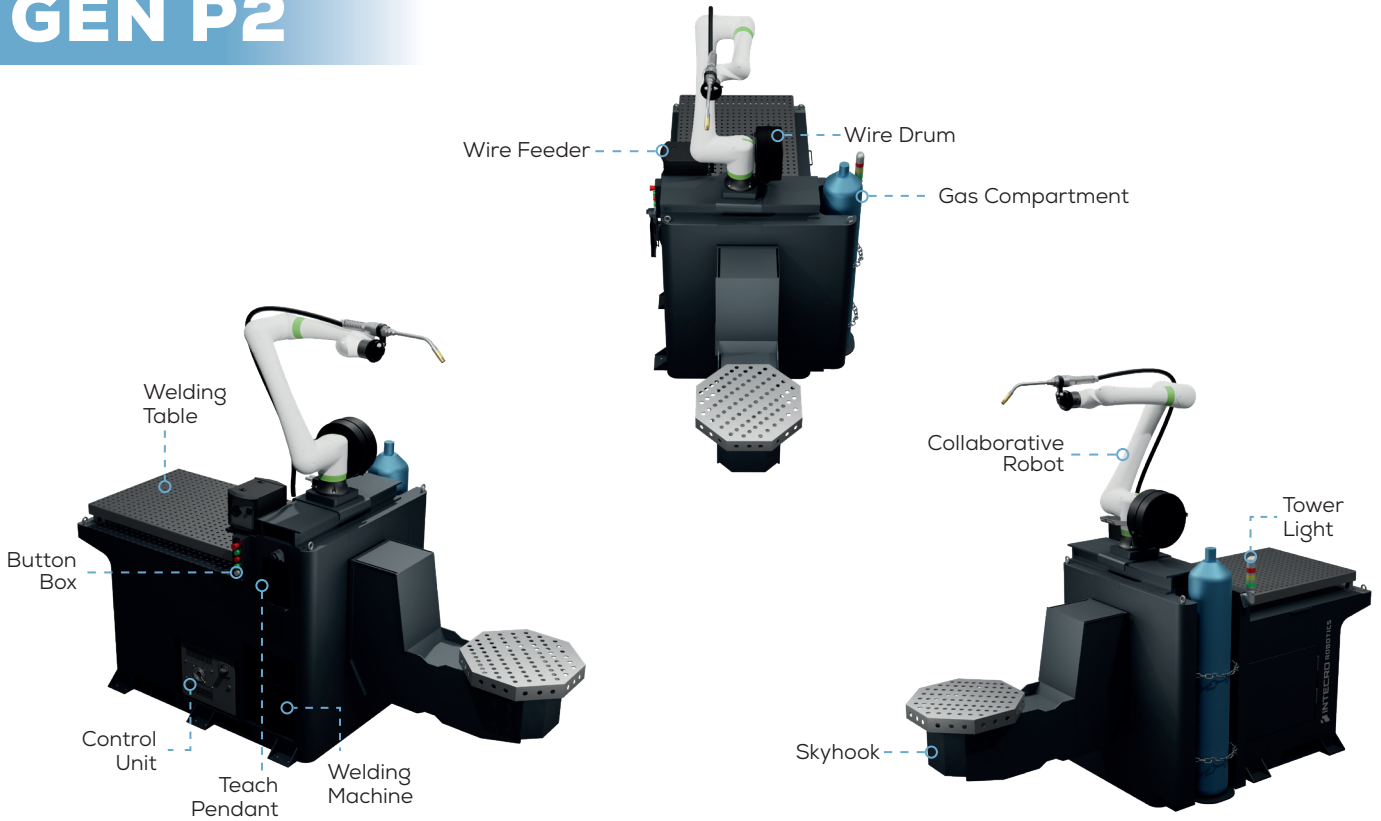

 Strong

 Rigid

 Balanced

Main Components

Collaborative Robot	Welding Torch	Storage Area
Welding Machine	Welding Wire Feeder	Casters & Feet
Positioner	Slag Compartment	Tube Attachment Chain
Safety Equipment	Part Fixing Equipment	Cleaning & Maintenance Equipment

Key Features:

- **Positioner Integrated System:** The positioner integration, which can hold the workpiece and rotate it in a controlled manner, ensures full compatibility with different welding scenarios.
- **Two Different Table Structures:** It offers flexible usage with two separate table configurations designed to suit different production needs.
- **Fixed, Yet Easily Transportable:** While maintaining the stability of a fixed installation, it provides practical use with mobility solutions that facilitate transportation and relocation processes.

Areas of Use:

- Manufacturing
- Automotive
- Infrastructure

Target

- SMEs
- Workshops
- Factories

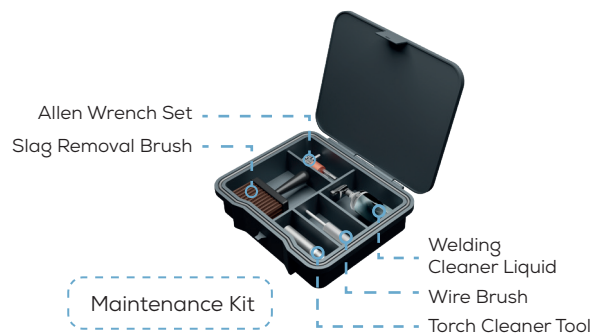

Technical Specifications:

Systems			
Model	GEN-P2		
Dimensions (W x D x H)	1000 x 3000 x 1400 mm		
Robot Specs			
Brand	Fanuc		
Model	CRX-10iA/L		
Axis	6		
Payload	10 kg		
Access Distance	1418 mm		
Repeability	± 0.04 mm		
Welding Power Source			
Standart		Optional	
Brand	FION MSP500*	Brand	ESAB Aristo 500ix
Type	MIG/MAG	Type	MIG/MAG
Current	3-500 A	Current	5-500 A
Voltage	400 V	Voltage	380-460 V
Welding Table		Compact Skyhook	
Brand	Siegmund	Brand	Robital Rhino Motion
Dimensions (W x D)	800 x 1200 mm	Capacity	1000 kg
Hole Dia.	16 mm	Turning Diameter	800 mm
		Rotational Velocity	0.5 RPM
		Repeatability	± 1.5 Arcmin

* 3 Current Options: 300 A, 400 A, 500 A

Mechanical Dimensions:

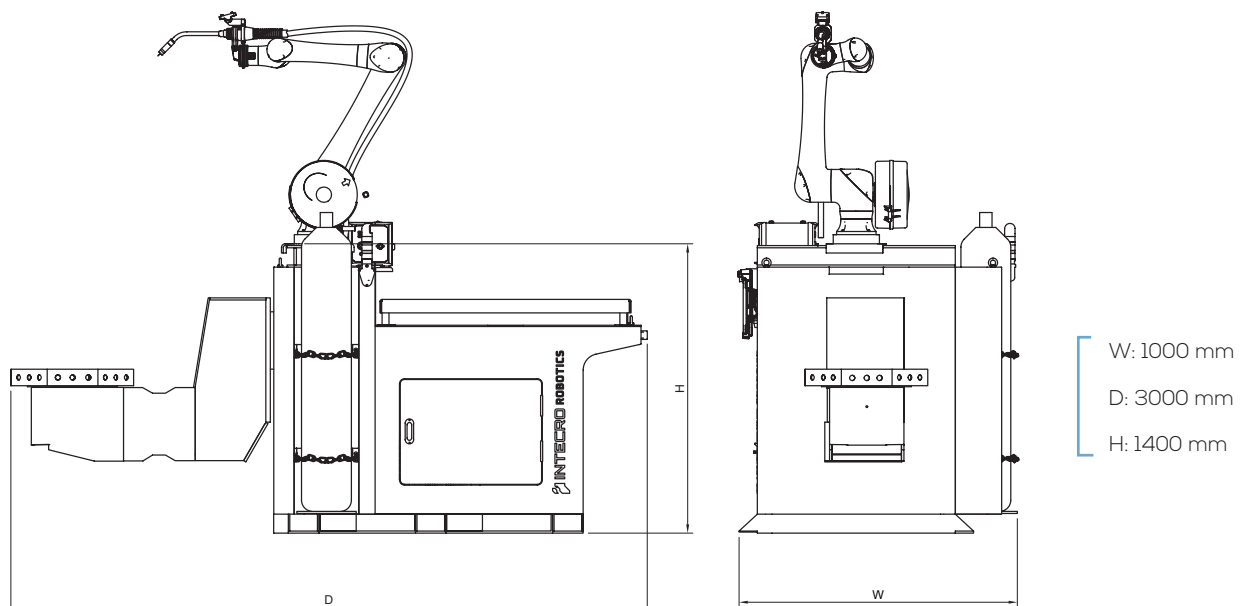

Main Softwares



Arcsense



Touchsense



Multilayer

Software Options:



Option List:



Gas Cylinder Cart



External Fume Extractor

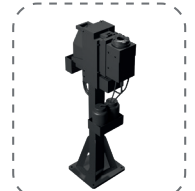

Automatic Torch Cleaner



 info@intecro.com.tr

 intecroroboticwelding.com

 +90 850 223 0 468 (INT)

 **ANKARA - VIA TOWER
MANAGEMENT-MARKETING-
SALES OFFICE**

Söğütözü Mah. Nergiz Sokak
No: 7/32 Yenimahalle 06560
Ankara/TÜRKİYE

 **ANKARA - YENİ BATI
ADMINISTRATIVE
OFFICE**

Yeni Batı Mah. 2400 Sokak
No: 13 Yenimahalle 06370
Ankara/TÜRKİYE

 **ANKARA - EMAI
MANUFACTURING -
ENGINEERING CAMPUS**

Sarayosb Mah. Uzay ve
Havacılık OSB NO: 187AA
K.Kazan 06980 ANKARA

 **BURSA - EFE TOWER
MANAGEMENT - MARKETING -
SALES OFFICE**

Odunluk Mah. Liman Cad.
B Blok, No: 11B Nilüfer 16265
Bursa/TÜRKİYE

 **CHICAGO - TTC
USA SALES - SERVICE
OFFICE**

11417 Irving Park Rd.
Franklin Park 60131
Illinois USA

“The Strong Start”

